

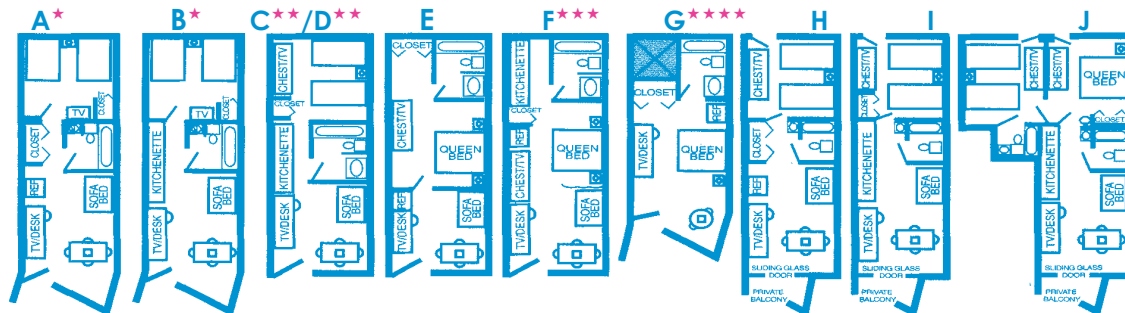

PHONE:  
609-522-3414



2019 DAILY RATE SCHEDULE  
WEEKENDS & HOLIDAYS ARE \$12.00 ABOVE RATE



STYLE OF UNIT	A*	B*	C**/D**	E	F***	G****	H	I	J
	MOTEL SUITE	EFFICIENCY APARTMENT	EFFICIENCY APARTMENT	MOTEL SUITE	EFFICIENCY APARTMENT	MOTEL ROOM	MOTEL SUITE	EFFICIENCY APARTMENT	EFFICIENCY APARTMENT
<b>SLEEPING AMENITIES</b>	Private Bedroom w/ 2 Double Beds Living Room w/ Full Sofa Bed Compact Refrigerator Microwave Coffee Maker 2 TV's - 2 Phones Full Bath w/ Shower Stall Central A/C Unit Semiprivate Balcony	Private Bedroom w/ 2 Double Beds Living/Dining Room w/ Full Sofa Bed Kitchenette w/ Stovetop, Full-Size Refrig. & Microwave 2 TV's - 2 Phones Full Bath w/ Shower Stall Central A/C Unit Semiprivate Balcony	Private Bedroom w/ 2 Double Beds Living/Dining Room w/ Full Sofa Bed Kitchenette w/ Stovetop, Full-Size Refrig. & Microwave 2 TV's - 2 Phones Full Bath w/ Shower Stall Central A/C Unit Semiprivate Balcony	Private Bedroom w/ 1 Queen Bed Living Room w/ Queen Sofa Bed Compact Refrigerator Microwave Coffee Maker 2 TV's - 2 Phones Full Bath w/ Shower Stall Central A/C Unit Semiprivate Balcony	1 Queen Bed 1 Queen Sofa Bed Living/Bdrm. Combo w/Divider Kitchenette w/ Stovetop, Full-Size Refrig. & Microwave 2 TV's - 2 Phones Full Bath w/ Shower Stall Central A/C Unit Semiprivate Balcony	1 Queen Bed Compact Refrigerator Microwave Coffee Maker 1 TV - 2 Phones Full Bath w/ Shower Stall Central A/C Unit Semiprivate Balcony	Private Bedroom w/ 2 Double Beds Living Room w/ Full Sofa Bed Compact Refrigerator Microwave Coffee Maker Full Bath w/tub 2 TV's 2 Phones 2 Central A/C Units Private Balcony	Private Bedroom w/ 2 Double Beds Living/Dining Room w/ Full Sofa Bed Kitchenette w/ Stovetop, Full-Size Refrig. & Microwave Full Bath w/tub 2 TV's 2 Phones 2 Central A/C Units Private Balcony	2 Private Bedrooms w/ 1 Queen Bed & 2 Double Beds Living/Dining Room w/ Queen Sofa Bed Kitchenette w/ Stovetop, Full-Size Refrig. & Microwave 1 full bath & 1 w/ shower stall 3 TV's, 3 Phones 3 Central A/C Units Private Balcony
<b>ROOM LOCATION</b> 5th Fl. East Wing Rooms Add \$12.00 per night	EAST WING	EAST WING	EAST WING	EAST WING	EAST WING	EAST WING	WEST WING	WEST WING	WEST WING
<b>VIEW</b>	POOL SIDE	POOL SIDE	BEACHFRONT	BEACHFRONT	BEACHFRONT	POOL SIDE	STREET SIDE	STREET SIDE	STREET SIDE
<b>IN SEASON</b>	RATES UP TO FOUR					FOR TWO	UP TO FOUR		UP TO EIGHT
June 23 - June 29 August 25 - Sept. 1	\$147	\$159	\$181	\$169	\$171	\$115	\$133	\$145	\$241
June 30 - July 11 August 18 - August 24 Labor Day Weekend	\$167	\$199	\$223	\$211	\$213	\$131	\$149	\$169	\$285
July 12 - Aug. 17 July 4th Holiday Wknd	\$193	\$219	\$243	\$223	\$225	\$143	\$169	\$191	\$307
<b>OFF SEASON</b>	RATES UP TO FOUR					FOR TWO	UP TO FOUR		UP TO EIGHT
June 6 - June 22 Sept. 2 - Sept. 14 See Memorial Day Wknd. Pkgs.	\$121	\$134	\$147	\$132	\$132	\$91	\$107	\$119	\$179
May 24 - June 5 Sept. 15 - Sept. 21	\$87	\$95	\$123	\$115	\$115	\$73	\$77	\$83	\$137
May 1 - May 23 Sept. 22 - Oct. 6	\$69	\$81	\$101	\$93	\$93	\$57	\$59	\$63	\$116

- \* ALSO AVAILABLE WITH 2 QUEEN BEDS VS. 2 DOUBLE BEDS AND QUEEN SOFA BED VS. FULL SOFA BED (5TH FLOOR ONLY).
- \*\* ALSO AVAILABLE WITH 1 KING BED VS. 2 DOUBLE BEDS OR 2 QUEEN BEDS VS. 2 DOUBLE BEDS. ROOMS INCLUDE QUEEN SIZE SOFA BEDS AND FULL BATH WITH TUB (5TH FLOOR ONLY).
- \*\*\* ALSO AVAILABLE WITH 1 KING BED VS. 1 QUEEN BED AND FULL BATH WITH TUB (5TH FLOOR ONLY).
- \*\*\*\* ALSO AVAILABLE WITH 2 DOUBLE BEDS AND FULL BATH WITH TUB VS. 1 QUEEN BED OR 1 KING BED (5TH FLOOR ONLY).

**AMENITIES:**

- Oceanfront Resort with Private Entrance to Beach
- Heated Olympic Size Adult Pool with Island
- Heated Children Fountain Pool
- Night Time Swimming every Wed. & Sat. 'til 10 pm (Memorial Day - Labor Day, weather permitting)
- Oceanview from Every Suite • Poolside & Rooftop Sundecks
- Private (West Wing) & Semi-Private (East Wing) Balconies
- Fully Equipped Efficiencies with Stovetop & Microwave
- All Units have Flat Screen Color TVs with Remote
- Refrigerators, Microwaves, Coffee Makers, Hair Dryers, Irons, Ironing Boards and Clock Radios in All Rooms
- Central Air Conditioning System
- 2 Phones in all rooms with 24 Hour Automatic Service
- Courteous Daily Maid Service
- Copy & Fax Service for your Business Needs
- Front Desk Safe Facility Available to Our Guests on a Complimentary Basis
- Barbecue Grills for your Outdoor Cooking Pleasure
- Game Room with Pinball and Electronic Games
- Table Tennis • Guest Laundromat • Bicycle Rack
- Outdoor Hot Tub • Cafe & Gift Shop • Snack & Vending Machines • 2 Self-Service Elevators • Self-Service Ice Machines
- Conference Facility for Groups or Conventions
- Cot & Crib Rentals Extra
- Wireless Internet Hot Zones • DVD & VCR Rentals Available
- Near Churches, Social Events, Bike Path, Lifeguard Station and Surfing beach
- Parking - One Car Per Unit
- Smoke Detector in All Rooms (Visual Smoke Detectors for the Hearing Impaired Available)

**DO YOU LIKE PACKAGE DEALS?  
SEE OUR SPECIALS FLYER!**

Visit our Web Site at:  
[www.royalhawaiianresort.com](http://www.royalhawaiianresort.com)

**CHECK-IN: AFTER 3:00 PM  
CHECK-OUT: BEFORE 10:00 AM**

ALL RATES INCLUDE A 5% DISCOUNT FOR PAYMENT IN CASH. PLEASE CALCULATE RATE FOR FORM OF PAYMENT ACCORDINGLY.

**PARKING:** Only ONE PARKING SPACE PER UNIT AVAILABLE. At no time will more than one car per unit be permitted on parking lot. Ample, free street parking is available nearby. 2 parking permits issued with J unit. Cannot guarantee parking for oversized vehicle.

**USE OF FACILITIES:** Facilities of the motel are for registered guest only. Visitors must register. Fee involved.  
**EXTRA PERSON IN ROOM:** In-season and Memorial Day Weekend - \$12.00 per Night. Off-season - \$6.00 per Night.

**RATES:** Pay CASH and save. All rates have been discounted 5% for the benefit of those who would like to pay in CASH. Add 5% to the rates to determine the full rate. Rates may not apply to Holidays or Weekends, Groups or Conventions. Please write or call for rate information. A three night minimum stay may be required. **N.J. Sales Tax and Tourism Tax of 13.625% is not included in the above rates. Gratuities not included.**

**DEPOSIT REQUIRED:** A deposit of one day rental is required to confirm reservations of three days or less. A deposit of two days rental is required to confirm reservations of four days or more.

Either would be credited to the last day(s) of the reservation. Reservations are held for one week only awaiting your deposit unless other arrangements have been made.

**PAYMENT:** YOUR BALANCE IS DUE IN FULL AT CHECK-IN, and is payable in CASH, MONEY ORDERS OR CERTIFIED CHECK. No personal checks accepted for the balance due at check-in. Personal checks are accepted for deposit only 2 weeks prior to arrival and are not transferable. Check Return Fee \$40.00.

**CANCELLATION POLICY:** Prior to 14 days of check-in date - 50% refund. Within 14 days of check-in date - 25% refund. Within 72 hours of check-in date - NO REFUND. Early check-outs NO REFUNDS. No shows - NO REFUNDS. Change of dates - NO REFUND. Weather related conditions - NO REFUNDS. Deposits with the use of a credit card - NO REFUND. Groups or Convention - 30 day notice required at a 50% refund. Mandatory Evacuation - NO REFUND, credit given for current year.

**AGE POLICY:** We do not rent out to young adults under the age of 21. Misrepresentation voids reservation with no refund.